

PRODUCT VIEW

SPECIFICATIONS

MODEL

DESCRIPTION

LessCare® Strainer for Kitchen, Bar and Prep Stainless Steel Sinks



LSTR1-B

- Stainless Steel Strainer
- Fits all LessCare stainless steel sinks
- Fits all stainless steel sinks with standard drain opening 3 1/2"
- Limited Lifetime Residential Warranty
- Intended Use: Residential / Commercial

LessCare® Top Mount Kitchen Sinks –304 Stainless Steel, 20 Gauge

Nest Packing

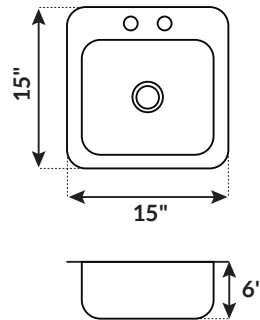

LT62

15" W x 15" L x 6" Deep

- Style: Top Mount Drop In Bar And Prep Sink
- Installation Type: Top Mount Drop In
- Material Construction: 304 Stainless Steel
- Stainless Steel Gauge: 20 Gauge
- Finish Type: Brushed Stainless Steel
- Drain Opening: 3 1/2" Standard
- Installation Mounting Hardware Included
- Installation Template Included
- Noise Block Sound Padded
- Noise Block Undercoated Sound Painted
- 4" Faucet Spread
- Warranty: Limited Lifetime Residential Warranty
- Intended Use: Residential / Commercial
- Nest packing

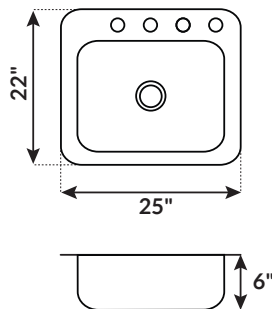

LT64

25" W x 22" L x 6" Deep

- Style: Top Mount Drop In Kitchen Sink
- Installation Type: Top Mount Drop In
- Material Construction: 304 Stainless Steel
- Stainless Steel Gauge: 20 Gauge
- Finish Type: Brushed Stainless Steel
- Drain Opening: 3 1/2" Standard
- Faucet Installation 3 Or 4 Holes With 1 Cover Cap Including
- Installation Mounting Hardware Included
- Installation Template Included
- Noise Block Sound Padded
- Noise Block Undercoated Sound Painted
- Warranty: Limited Lifetime Residential Warranty
- Intended Use: Residential / Commercial
- Nest packing

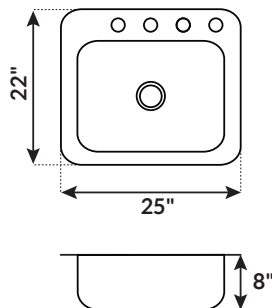

LT84

25" W x 22" L x 8" Deep

- Style: Top-mount Kitchen Sink
- Material Construction: Stainless Steel
- Stainless Steel Gauge: 20 Gauge
- Stainless Steel Type: 304
- 3 faucet holes (4" faucet spread) + 1 hole for sprayer or soap dispenser
- 1 cover cap for 3 hole faucet installation included
- Finish type: Brushed Stainless Steel
- Drain Opening: 3 1/2" Standard
- Installation Mounting hardware Included
- Bottom is coated and padded for noise elimination
- Strainer is not included
- Limited Lifetime Residential Warranty
- Intended Use: Residential / Commercial
- Nest packing

MIX & MATCH ANY SINKS IN ACCORDANCE TO "MINIMUM ORDER" RANGE*

Sinks from different categories can not be combined together. (Example: undermount sinks can not be combined with top mount sinks)

Due to manufacturing process, product dimensions may have a tolerance. Images and specs are for reference only and may not be completely accurate.

PRODUCT VIEW

SPECIFICATIONS

MODEL

DESCRIPTION

LessCare® Top Mount Kitchen Sinks – 304 Stainless Steel, 20 Gauge

Nest Packing

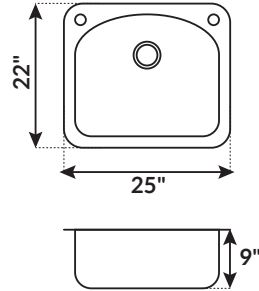

LT91

25" W x 22" L x 9" Deep

- Style: Top Mount Drop In Kitchen Sink
- Installation Type: Top Mount Drop In
- Material Construction: 304 Stainless Steel
- Stainless Steel Gauge: 20 Gauge
- Finish Type: Brushed Stainless Steel
- Drain Opening: 3 1/2" Standard
- Faucet Installation 3 Or 4 Holes With 1 Cover Cap Including
- Installation Mounting Hardware Included
- Installation Template Included
- Noise Block Sound Padded
- Noise Block Undercoated Sound Painted
- Strainer Not Included
- Warranty: Limited Lifetime Residential Warranty
- Intended Use: Residential / Commercial
- Nest Packing

Nest Packing

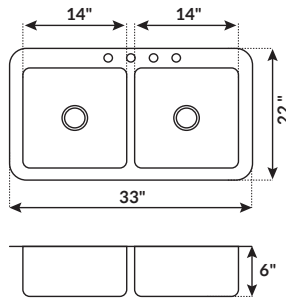

LTD64

33" W x 22" L x 6" Deep

- Style: Top Mount Drop In Double Kitchen Sink
- Installation Type: Top Mount Drop In
- Material Construction: 304 Stainless Steel
- Stainless Steel Gauge: 20 Gauge
- Finish Type: Brushed Stainless Steel
- Drain Opening: 3 1/2" Standard
- Faucet Installation 3 Or 4 Holes With 1 Cover Cap Including
- Installation Mounting Hardware Included
- Installation Template Included
- Noise Block Sound Padded
- Noise Block Undercoated Sound Painted
- Strainer Not Included
- Warranty: Limited Lifetime Residential Warranty
- Intended Use: Residential / Commercial
- Nest packing

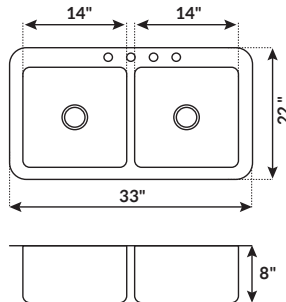

LTD84

33" W x 22" L x 8" Deep

- Style: Top Mount Drop In Double Kitchen Sink
- Installation Type: Top Mount Drop In
- Material Construction: 304 Stainless Steel
- Stainless Steel Gauge: 20 Gauge
- Finish Type: Brushed Stainless Steel
- Drain Opening: 3 1/2" Standard
- Faucet Installation 3 Or 4 Holes With 1 Cover Cap Including
- Installation Mounting Hardware Included
- Installation Template Included
- Noise Block Sound Padded
- Noise Block Undercoated Sound Painted
- Strainer Not Included
- Warranty: Limited Lifetime Residential Warranty
- Intended Use: Residential / Commercial
- Nest packing

LessCare® Undermount Bar and Prep Sinks – 304 Stainless Steel, 18 Gauge

Single Box Packing

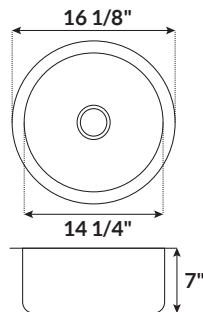

L101



16 1/8" W x 7" Deep

- Style: Undermount or Top mount Bar and Prep Sink
- Installation Type: Undermount/Top mount
- Material Construction: Stainless Steel
- Stainless Steel Gauge: 18 Gauge
- Stainless Steel Type: 304
- Finish Type: Brushed Stainless Steel
- Drain Opening: 3 1/2" Standard
- Installation Mounting Hardware Included
- Installation Template Included
- Noise Block Sound Padded
- Noise Block Undercoated Sound Painted
- Strainer is not included
- Limited Lifetime Residential Warranty
- Intended Use: Residential / Commercial
- Single Box Packing

MIX & MATCH ANY SINKS IN ACCORDANCE TO "MINIMUM ORDER" RANGE*

Sinks from different categories can not be combined together. (Example: undermount sinks can not be combined with top mount sinks)

Due to manufacturing process, product dimensions may have a tolerance. Images and specs are for reference only and may not be completely accurate.

PRODUCT VIEW

SPECIFICATIONS

MODEL

DESCRIPTION

LessCare® Undermount Bar and Prep Sinks – 304 Stainless Steel, 18 Gauge

Single Box Packing

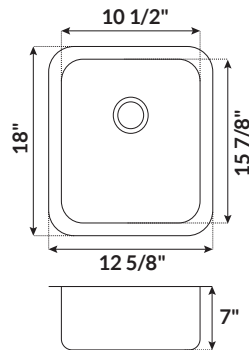

L102



12 5/8" W x 18" L x 7" Deep

- Style: Undermount Bar and Prep Sink
- Installation Type: Undermount
- Material Construction: Stainless Steel
- Stainless Steel Gauge: 18 Gauge
- Stainless Steel Type: 304
- Finish Type: Brushed Stainless Steel
- Drain Opening: 3 1/2" Standard
- Installation Mounting Hardware Included
- Installation Template Included
- Noise Block Sound Padded
- Noise Block Undercoated Sound Painted
- Strainer is not included
- Limited Lifetime Residential Warranty
- Intended Use: Residential / Commercial
- Single Box Packing

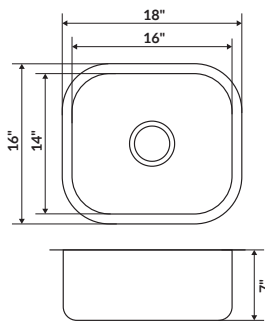

L103



18" W x 16" L x 7" Deep

- Style: Undermount Bar and Prep Sink
- Installation Type: Undermount
- Material Construction: Stainless Steel
- Stainless Steel Gauge: 18 Gauge
- Stainless Steel Type: 304
- Finish Type: Brushed Stainless Steel
- Drain Opening: 3 1/2" Standard
- Installation Mounting Hardware Included
- Installation Template Included
- Noise Block Sound Padded
- Noise Block Undercoated Sound Painted
- Strainer is not included
- Limited Lifetime Residential Warranty
- Intended Use: Residential / Commercial
- Single Box Packing

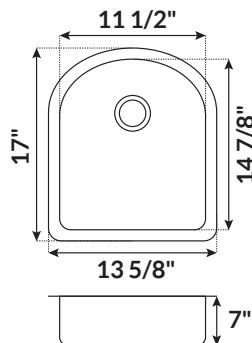

L104



13 5/8" W x 17" L x 7" Deep

- Style: Undermount Bar and Prep Sink
- Installation Type: Undermount
- Material Construction: Stainless Steel
- Stainless Steel Gauge: 18 Gauge
- Stainless Steel Type: 304
- Finish Type: Brushed Stainless Steel
- Drain Opening: 3 1/2" Standard
- Installation Mounting Hardware Included
- Installation Template Included
- Noise Block Sound Padded
- Noise Block Undercoated Sound Painted
- Strainer is not included
- Limited Lifetime Residential Warranty
- Intended Use: Residential / Commercial
- Single Box Packing

LessCare® Undermount Kitchen Sinks – 304 Stainless Steel, 18 Gauge

Single Box Packing

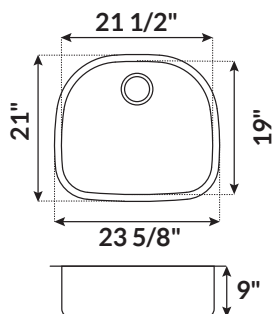

L105



23 5/8" W x 21" L - 9" Deep

- Style: Undermount Kitchen Sink
- Installation Type: Undermount
- Material Construction: Stainless Steel
- Stainless Steel Gauge: 18 Gauge
- Stainless Steel Type: 304
- Finish type: Brushed Stainless Steel
- Drain Opening: 3 1/2" Standard
- Installation Mounting hardware Included
- Installation Template included
- Noise Block Sound Padded
- Noise Block Undercoated Sound Painted
- Strainer is not included
- Limited Lifetime Residential Warranty
- Intended Use: Residential / Commercial
- Single Box Packing

MIX & MATCH ANY SINKS IN ACCORDANCE TO "MINIMUM ORDER" RANGE*

Sinks from different categories can not be combined together. (Example: undermount sinks can not be combined with top mount sinks)

Due to manufacturing process, product dimensions may have a tolerance. Images and specs are for reference only and may not be completely accurate.

PRODUCT VIEW

SPECIFICATIONS

MODEL

DESCRIPTION

LessCare® Undermount Kitchen Sinks – 304 Stainless Steel, 18 Gauge

Pallet Packing

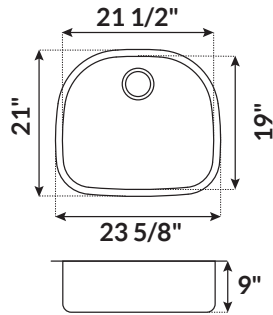

L105



23 5/8" W x 21" L - 9" Deep

- Style: Undermount Kitchen Sink
- Installation Type: Undermount
- Material Construction: Stainless Steel
- Stainless Steel Gauge: 18 Gauge
- Stainless Steel Type: 304
- Finish type: Brushed Stainless Steel
- Drain Opening: 3 1/2" Standard
- Installation Mounting hardware Included
- Installation Template included
- Noise Block Sound Padded
- Noise Block Undercoated Sound Painted
- Strainer is not included
- Limited Lifetime Residential Warranty
- Intended Use: Residential / Commercial
- Pallet packing

LessCare® Undermount Kitchen Sinks – 304 Stainless Steel, 18 Gauge

Single Box Packing

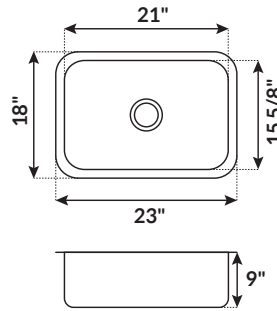

L106



23" W x 18" L - 9" Deep

- Style: Undermount Kitchen Sink
- Installation Type: Undermount
- Material Construction: Stainless Steel
- Stainless Steel Gauge: 18 Gauge
- Stainless Steel Type: 304
- Finish type: Brushed Stainless Steel
- Drain Opening: 3 1/2" Standard
- Installation Mounting hardware Included
- Installation Template included
- Noise Block Sound Padded
- Noise Block Undercoated Sound Painted
- Strainer is not included
- Limited Lifetime Residential Warranty
- Intended Use: Residential / Commercial

Pallet Packing

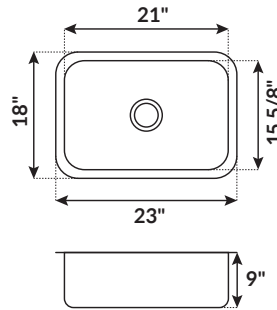

L106



23" W x 18" L - 9" Deep

- Style: Undermount Kitchen Sink
- Installation Type: Undermount
- Material Construction: Stainless Steel
- Stainless Steel Gauge: 18 Gauge
- Stainless Steel Type: 304
- Finish type: Brushed Stainless Steel
- Drain Opening: 3 1/2" Standard
- Installation Mounting hardware Included
- Installation Template included
- Noise Block Sound Padded
- Noise Block Undercoated Sound Painted
- Strainer is not included
- Limited Lifetime Residential Warranty
- Intended Use: Residential / Commercial
- Pallet packing

Single Box Packing

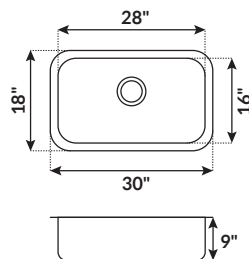

L107-9



30" W x 18" L x 9" Deep

- Style: Undermount Kitchen Sink
- Installation Type: Undermount
- Material Construction: Stainless Steel
- Stainless Steel Gauge: 18 Gauge
- Stainless Steel Type: 304
- Finish type: Brushed Stainless Steel
- Drain Opening: 3 1/2" Standard
- Installation Mounting hardware Included
- Installation Template included
- Noise Block Sound Padded
- Noise Block Undercoated Sound Painted
- Strainer is not included
- Limited Lifetime Residential Warranty
- Intended Use: Residential / Commercial

MIX & MATCH ANY SINKS IN ACCORDANCE TO "MINIMUM ORDER" RANGE*

Sinks from different categories can not be combined together. (Example: undermount sinks can not be combined with top mount sinks)

Due to manufacturing process, product dimensions may have a tolerance. Images and specs are for reference only and may not be completely accurate.

PRODUCT VIEW

SPECIFICATIONS

MODEL

DESCRIPTION

LessCare® Undermount Kitchen Sinks – 304 Stainless Steel, 18 Gauge

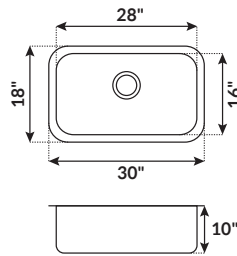

- 30" W x 18" L x 10" Deep**
- Style: Undermount Kitchen Sink
 - Installation Type: Undermount
 - Material Construction: Stainless Steel
 - Stainless Steel Gauge: 18 Gauge
 - Stainless Steel Type: 304
 - Finish type: Brushed Stainless Steel
 - Drain Opening: 3 1/2" Standard
 - Installation Mounting hardware Included
 - Installation Template included
 - Noise Block Sound Padded
 - Noise Block Undercoated Sound Painted
 - Strainer is not included
 - Limited Lifetime Residential Warranty
 - Intended Use: Residential / Commercial

Pallet Packing

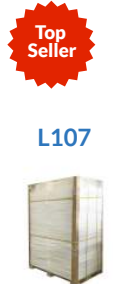
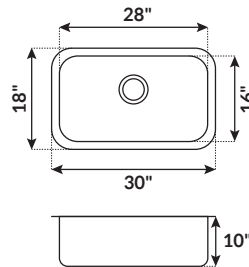

- 30" W x 18" L x 10" Deep**
- Style: Undermount Kitchen Sink
 - Installation Type: Undermount
 - Material Construction: Stainless Steel
 - Stainless Steel Gauge: 18 Gauge
 - Stainless Steel Type: 304
 - Finish type: Brushed Stainless Steel
 - Drain Opening: 3 1/2" Standard
 - Installation Mounting hardware Included
 - Installation Template included
 - Noise Block Sound Padded
 - Noise Block Undercoated Sound Painted
 - Strainer is not included
 - Limited Lifetime Residential Warranty
 - Intended Use: Residential / Commercial
 - Pallet packing

Single Box Packing

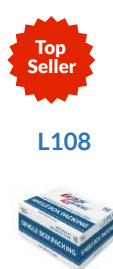
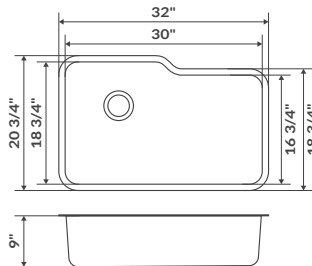

- 32" W x 20 3/4" L x 9" Deep**
- Style: Undermount Kitchen Sink
 - Installation Type: Undermount
 - Material Construction: Stainless Steel
 - Stainless Steel Gauge: 18 Gauge
 - Stainless Steel Type: 304
 - Finish type: Brushed Stainless Steel
 - Drain Opening: 3 1/2" Standard
 - Installation Mounting hardware Included
 - Installation Template included
 - Noise Block Sound Padded
 - Noise Block Undercoated Sound Painted
 - Strainer is not included
 - Limited Lifetime Residential Warranty
 - Intended Use: Residential / Commercial

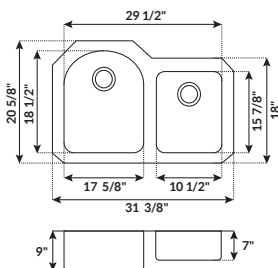

- 31 3/8" W x 20 5/8" L x 9" / 7" Deep (70/30)**
- Style: Undermount Double Kitchen Sink
 - Installation Type: Undermount
 - Material Construction: Stainless Steel
 - Stainless Steel Gauge: 18 Gauge
 - Stainless Steel Type: 304
 - Finish type: Brushed Stainless Steel
 - Drain Opening: 3 1/2" Standard
 - Installation Mounting hardware Included
 - Installation Template included
 - Noise Block Sound Padded
 - Noise Block Undercoated Sound Painted
 - Strainer is not included
 - Limited Lifetime Residential Warranty
 - Intended Use: Residential / Commercial

Single Box Packing

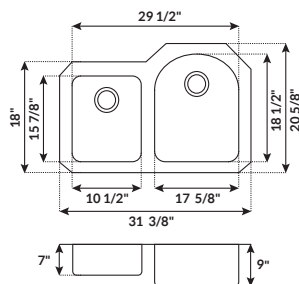

- 31 3/8" W x 20 5/8" L x 7" / 9" Deep (30/70)**
- Style: Undermount Double Kitchen Sink
 - Installation Type: Undermount
 - Material Construction: Stainless Steel
 - Stainless Steel Gauge: 18 Gauge
 - Stainless Steel Type: 304
 - Finish type: Brushed Stainless Steel
 - Drain Opening: 3 1/2" Standard
 - Installation Mounting hardware Included
 - Installation Template included
 - Noise Block Sound Padded
 - Noise Block Undercoated Sound Painted
 - Strainer is not included
 - Limited Lifetime Residential Warranty
 - Intended Use: Residential / Commercial
 - Single Box Packing

MIX & MATCH ANY SINKS IN ACCORDANCE TO "MINIMUM ORDER" RANGE*

Sinks from different categories can not be combined together. (Example: undermount sinks can not be combined with top mount sinks)

Due to manufacturing process, product dimensions may have a tolerance. Images and specs are for reference only and may not be completely accurate.

PRODUCT VIEW

SPECIFICATIONS

MODEL

DESCRIPTION

LessCare® Undermount Kitchen Sinks – 304 Stainless Steel, 18 Gauge

Single Box Packing

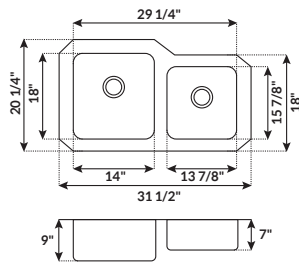

L202R



31 1/2" W x 20 1/4" L x 9" / 7" Deep (50/50)

- Style: Undermount Double Kitchen Sink
- Installation Type: Undermount
- Material Construction: Stainless Steel
- Stainless Steel Gauge: 18 Gauge
- Stainless Steel Type: 304
- Finish type: Brushed Stainless Steel
- Drain Opening: 3 1/2" Standard
- Installation Mounting hardware Included
- Installation Template included
- Noise Block Sound Padded
- Noise Block Undercoated Sound Painted
- Strainer is not included
- Limited Lifetime Residential Warranty
- Intended Use: Residential / Commercial
- Single Box Packing

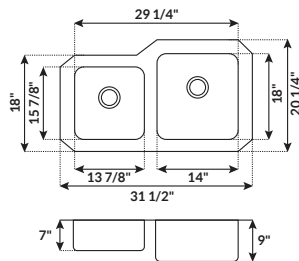

L202L



31 1/2" W x 20 1/4" L x 7" / 9" Deep (50/50)

- Style: Undermount Double Kitchen Sink
- Installation Type: Undermount
- Material Construction: Stainless Steel
- Stainless Steel Gauge: 18 Gauge
- Stainless Steel Type: 304
- Finish type: Brushed Stainless Steel
- Drain Opening: 3 1/2" Standard
- Installation Mounting hardware Included
- Installation Template included
- Noise Block Sound Padded
- Noise Block Undercoated Sound Painted
- Strainer is not included
- Limited Lifetime Residential Warranty
- Intended Use: Residential / Commercial
- Single Box Packing

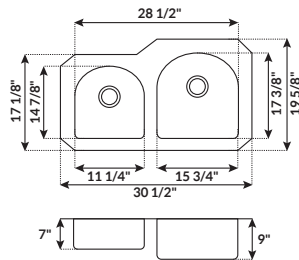

L203L



30 1/2" W x 19 5/8" L x 7" / 9" Deep (40/60)

- Style: Undermount Double Kitchen Sink
- Installation Type: Undermount
- Material Construction: Stainless Steel
- Stainless Steel Gauge: 18 Gauge
- Stainless Steel Type: 304
- Finish type: Brushed Stainless Steel
- Drain Opening: 3 1/2" Standard
- Installation Mounting hardware Included
- Installation Template included
- Noise Block Sound Padded
- Noise Block Undercoated Sound Painted
- Strainer is not included
- Limited Lifetime Residential Warranty
- Intended Use: Residential / Commercial
- Single Box Packing

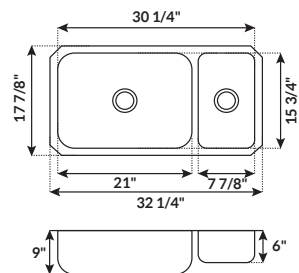

L204R/L



32 1/4" W x 17 7/8" L x 9" / 6" Deep (70/30)

- Style: Undermount Double Kitchen Sink
- Installation Type: Undermount, Reversible
- Material Construction: Stainless Steel
- Stainless Steel Gauge: 18 Gauge
- Stainless Steel Type: 304
- Finish type: Brushed Stainless Steel
- Drain Opening: 3 1/2" Standard
- Installation Mounting hardware Included
- Installation Template included
- Noise Block Sound Padded
- Noise Block Undercoated Sound Painted
- Strainer is not included
- Limited Lifetime Residential Warranty
- Intended Use: Residential / Commercial
- Single Box Packing

MIX & MATCH ANY SINKS IN ACCORDANCE TO "MINIMUM ORDER" RANGE*

Sinks from different categories can not be combined together. (Example: undermount sinks can not be combined with top mount sinks)

PRODUCT VIEW

SPECIFICATIONS

MODEL

DESCRIPTION

LessCare® Undermount Kitchen Sinks – 304 Stainless Steel, 18 Gauge

Single Box Packing

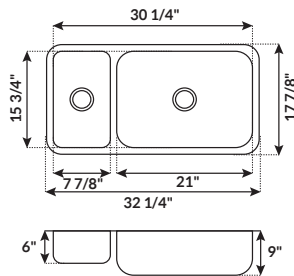

L204R/L



32 1/4" W x 17 7/8" L x 6" / 9" Deep (30/70)

- Style: Undermount Double Kitchen Sink
- Installation Type: Undermount, Reversible
- Material Construction: Stainless Steel
- Stainless Steel Gauge: 18 Gauge
- Stainless Steel Type: 304
- Finish type: Brushed Stainless Steel
- Drain Opening: 3 1/2" Standard
- Installation Mounting hardware Included
- Installation Template included
- Noise Block Sound Padded
- Noise Block Undercoated Sound Painted
- Strainer is not included
- Limited Lifetime Residential Warranty
- Intended Use: Residential / Commercial
- Single Box Packing

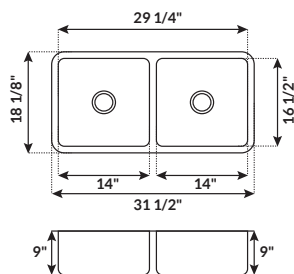

L205



31 1/2" W x 18 1/8" L x 9" Deep (50/50)

- Style: Undermount Double Kitchen Sink
- Installation Type: Undermount
- Material Construction: Stainless Steel
- Stainless Steel Gauge: 18 Gauge
- Stainless Steel Type: 304
- Finish type: Brushed Stainless Steel
- Drain Opening: 3 1/2" Standard
- Installation Mounting hardware Included
- Installation Template included
- Noise Block Sound Padded
- Noise Block Undercoated Sound Painted
- Strainer is not included
- Limited Lifetime Residential Warranty
- Intended Use: Residential / Commercial
- Single Box Packing

Pallet Packing

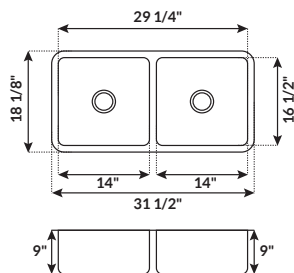

L205



31 1/2" W x 18 1/8" L x 9" Deep (50/50)

- Style: Undermount Double Kitchen Sink
- Installation Type: Undermount
- Material Construction: Stainless Steel
- Stainless Steel Gauge: 18 Gauge
- Stainless Steel Type: 304
- Finish type: Brushed Stainless Steel
- Drain Opening: 3 1/2" Standard
- Installation Mounting hardware Included
- Installation Template included
- Noise Block Sound Padded
- Noise Block Undercoated Sound Painted
- Strainer is not included
- Limited Lifetime Residential Warranty
- Intended Use: Residential / Commercial
- Single Box Packing

LessCare® Designer Undermount Kitchen Sinks – 304 Stainless Steel, 18 Gauge

Single Box Packing

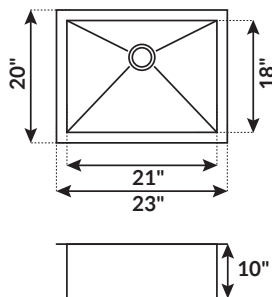

LP1



23" W x 20" L x 10" Deep

- Undermount Designer Zero Radius Kitchen Sink
- Installation Type: Undermount
- Material Construction: Stainless Steel
- Stainless Steel Gauge: 18 Gauge
- Stainless Steel Type: 304
- Finish type: Brushed Stainless Steel
- Drain Opening: 3 1/2" Standard
- Installation Mounting hardware Included
- Installation Template included
- Noise Block Sound Padded
- Noise Block Undercoated Sound Painted
- Strainer is not included
- Limited Lifetime Residential Warranty
- Intended Use: Residential / Commercial
- Single Box Packing

MIX & MATCH ANY SINKS IN ACCORDANCE TO "MINIMUM ORDER" RANGE*

Sinks from different categories can not be combined together. (Example: undermount sinks can not be combined with top mount sinks)

Due to manufacturing process, product dimensions may have a tolerance. Images and specs are for reference only and may not be completely accurate.

PRODUCT VIEW

SPECIFICATIONS

MODEL

DESCRIPTION

LessCare® Designer Undermount Kitchen Sinks – 304 Stainless Steel, 18 Gauge

Single Box Packing

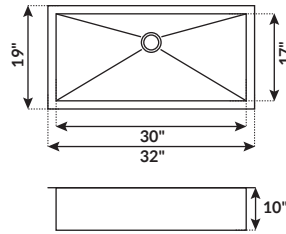

LP2



32" W x 19" L x 10" Deep

- Style: Undermount Designer Zero Radius Kitchen Sink
- Installation Type: Undermount
- Material Construction: Stainless Steel
- Stainless Steel Gauge: 18 Gauge
- Stainless Steel Type: 304
- Finish type: Brushed Stainless Steel
- Drain Opening: 3 1/2" Standard
- Installation Mounting hardware Included
- Installation Template included
- Noise Block Sound Padded
- Noise Block Undercoated Sound Painted
- Strainer is not included
- Limited Lifetime Residential Warranty
- Intended Use: Residential / Commercial
- Single Box Packing

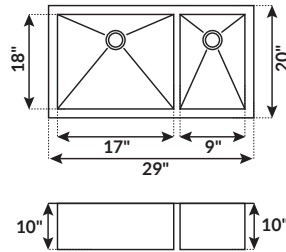

LP3R



29" W x 20" L x 10" Deep (70/30)

- Style: Undermount Designer Zero Radius Double Kitchen Sink
- Installation Type: Undermount
- Material Construction: Stainless Steel
- Stainless Steel Gauge: 18 Gauge
- Stainless Steel Type: 304
- Finish type: Brushed Stainless Steel
- Drain Opening: 3 1/2" Standard
- Installation Mounting hardware Included
- Installation Template included
- Noise Block Sound Padded
- Noise Block Undercoated Sound Painted
- Strainer is not included
- Limited Lifetime Residential Warranty
- Intended Use: Residential / Commercial
- Single Box Packing

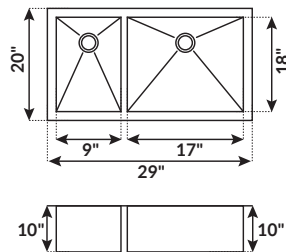

LP3L



29" W x 20" L x 10" Deep (30/70)

- Style: Undermount Designer Zero Radius Double Kitchen Sink
- Installation Type: Undermount
- Material Construction: Stainless Steel
- Stainless Steel Gauge: 18 Gauge
- Stainless Steel Type: 304
- Finish type: Brushed Stainless Steel
- Drain Opening: 3 1/2" Standard
- Installation Mounting hardware Included
- Installation Template included
- Noise Block Sound Padded
- Noise Block Undercoated Sound Painted
- Strainer is not included
- Limited Lifetime Residential Warranty
- Intended Use: Residential / Commercial
- Single Box Packing

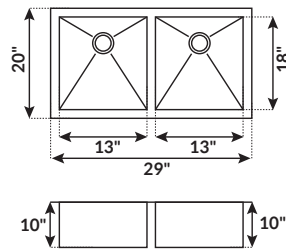

LP5



29" W x 20" L x 10" Deep (50/50)

- Style: Undermount Designer Zero Radius Double Kitchen Sink
- Installation Type: Undermount
- Material Construction: Stainless Steel
- Stainless Steel Gauge: 18 Gauge
- Stainless Steel Type: 304
- Finish type: Brushed Stainless Steel
- Drain Opening: 3 1/2" Standard
- Installation Mounting hardware Included
- Installation Template included
- Noise Block Sound Padded
- Noise Block Undercoated Sound Painted
- Strainer is not included
- Limited Lifetime Residential Warranty
- Intended Use: Residential / Commercial
- Single Box Packing

MIX & MATCH ANY SINKS IN ACCORDANCE TO "MINIMUM ORDER" RANGE*
 Sinks from different categories can not be combined together. (Example: undermount sinks can not be combined with top mount sinks)

Due to manufacturing process, product dimensions may have a tolerance. Images and specs are for reference only and may not be completely accurate.

PRODUCT VIEW

SPECIFICATIONS

MODEL

DESCRIPTION

LessCare® Full Front Apron Farmhouse Kitchen Sinks

Single Box Packing

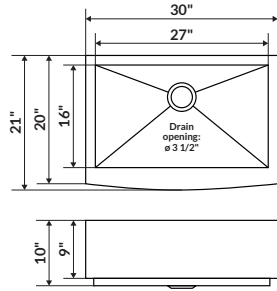

**NEW!
IN STOCK!**

LPF1



30" W x 21" L x 10" Deep

- Style: curved farmhouse full apron kitchen sink
- Installation type: undermount, flush-mount, built-up
- Sink apron sides are finished
- Curved front farmhouse apron
- Designer zero radius inner sink
- Material construction: stainless steel
- Stainless steel gauge: 16 gauge
- Stainless steel type: 304
- Finish type: brushed stainless steel
- Individually handmade craftsmanship
- Drain opening: 3 1/2" standard
- Noise block sound padded
- Strainer is not included

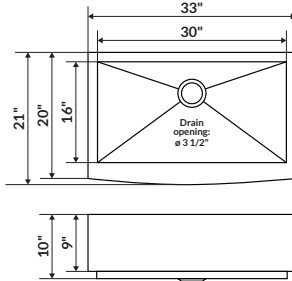

**NEW!
IN STOCK!**

LPF2



33" W x 21" L x 10" Deep

- Style: curved farmhouse full apron kitchen sink
- Installation type: undermount, flush-mount, built-up
- Sink apron sides are finished
- Curved front farmhouse apron
- Designer zero radius inner sink
- Material construction: stainless steel
- Stainless steel gauge: 16 gauge
- Stainless steel type: 304
- Finish type: brushed stainless steel
- Individually handmade craftsmanship
- Drain opening: 3 1/2" standard
- Noise block sound padded
- Strainer is not included

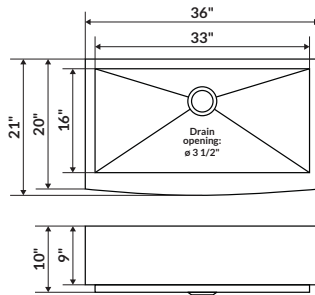

**NEW!
IN STOCK!**

LPF3



36" W x 21" L x 10" Deep

- Style: curved farmhouse full apron kitchen sink
- Installation type: undermount, flush-mount, built-up
- Sink apron sides are finished
- Curved front farmhouse apron
- Designer zero radius inner sink
- Material construction: stainless steel
- Stainless steel gauge: 16 gauge
- Stainless steel type: 304
- Finish type: brushed stainless steel
- Individually handmade craftsmanship
- Drain opening: 3 1/2" standard
- Noise block sound padded
- Strainer is not included

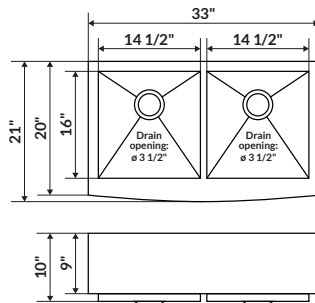

**NEW!
IN STOCK!**

LPF4



33" W x 21" L x 10" Deep

- Style: curved farmhouse full apron kitchen sink
- Installation type: undermount, flush-mount, built-up
- Sink apron sides are finished
- Curved front farmhouse apron
- Designer zero radius inner sink
- Material construction: stainless steel
- Stainless steel gauge: 16 gauge
- Stainless steel type: 304
- Finish type: brushed stainless steel
- Individually handmade craftsmanship
- Drain opening: 3 1/2" standard
- Noise block sound padded
- Strainer is not included

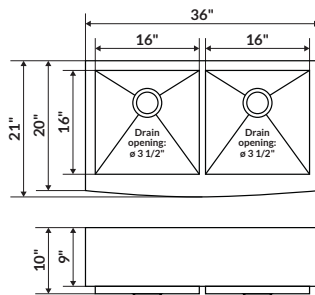

**NEW!
IN STOCK!**

LPF5



36" W x 21" L x 10" Deep

- Style: curved farmhouse full apron kitchen sink
- Installation type: undermount, flush-mount, built-up
- Sink apron sides are finished
- Curved front farmhouse apron
- Designer zero radius inner sink
- Material construction: stainless steel
- Stainless steel gauge: 16 gauge
- Stainless steel type: 304
- Finish type: brushed stainless steel
- Individually handmade craftsmanship
- Drain opening: 3 1/2" standard
- Noise block sound padded
- Strainer is not included

MIX & MATCH ANY SINKS IN ACCORDANCE TO "MINIMUM ORDER" RANGE*

Sinks from different categories can not be combined together. (Example: undermount sinks can not be combined with top mount sinks)

Due to manufacturing process, product dimensions may have a tolerance. Images and specs are for reference only and may not be completely accurate.